

VICTROLA™



USB Turntable

Model: VPRO-3100

Instruction Manual

PLEASE READ THIS INSTRUCTION MANUAL CAREFULLY BEFORE USE
AND KEEP IT FOR FUTURE REFERENCE.

CONTENTS

SAFETY INSTRUCTIONS	2
SPECIFICATIONS	3
TURNTABLE LAYOUT.....	4
ASSEMBLY OF THE DUST COVER.....	5
TURNTABLE OPERATION	5
SET UP.....	5
BASIC OPERATION	5
AUTO RETURN RESET	6
HOW TO REPLACE THE NEEDLE	6
IF THE BELT BECOMES LOOSE.....	7
TIPS FOR BETTER TURNTABLE USE	7
USB RECORDING OPERATION	7
FCC STATEMENT	8
CALIFORNIA PROP 65 WARNING.....	8
IT WARRANTY.....	8

SAFETY INSTRUCTIONS

1. Read these instructions – All the safety and operating instructions should be read before this product is operated.
2. Keep these instructions – The safety and operating instructions should be retained for future reference.
3. Heed all warnings – All warnings on the appliance and in the operating instructions should be adhered to.
4. Follow all instructions – All operating and use instructions should be followed.
5. Do not use this apparatus near water – The appliance should not be used near water or moisture – for example, in a wet basement, near a swimming pool, or near other wet areas.
6. Clean only with a dry cloth.
7. Do not block any ventilation openings. Keep at least 5 cm around the apparatus for sufficient ventilations. Install in accordance with the manufacturer's instructions.
8. Do not install near any heat sources such as radiators, heat registers, stoves, or other apparatus (including amplifiers) that produce heat.
9. Do not defeat the safety purpose of the polarized or grounding plug. A polarized plug has two blades with one wider than the other. A grounding plug has two blades and a third grounding prong. The wide blade or the third prong is provided for your safety. If the provided plug does not fit into your outlet, consult an electrician for replacement of the obsolete outlet.
10. Protect the power cord from being walked on or pinched particularly at the plugs, convenience receptacles, and at the point where they exit from the apparatus.
11. Only use attachments/accessories specified by the manufacturer.
12. Use only with the cart, stand, tripod, bracket, or table specified by the manufacturer, or sold with the apparatus. When a cart or rack is used, use caution when moving the cart/apparatus combination to avoid injury from tip-over.
13. Unplug the apparatus during lightning storms or when unused for long periods of time.
14. Refer all servicing to qualified personnel. Servicing is required when the apparatus has been damaged in any way, such as power supply cord or plug is damaged, liquid has been spilled or objects have fallen into the apparatus, the apparatus has been exposed to rain or moisture, does not operate normally, or has been dropped.
15. Please keep the unit in a well ventilated environment.
16. Only use attachments/accessories specified or provided by the manufacturer
17. To reduce the risk of fire or electric shock, do not expose this apparatus to rain or moisture. The apparatus shall not be exposed to dripping or splashing and no objects filled with liquids, such as vases, shall not be placed on apparatus.
18. The main plug is used as disconnect device, the disconnected device shall remain readily operable.
19. This product is not intended for commercial use. Household Use Only.

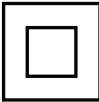

20.  This equipment is a Class II or double insulated electrical appliance. It has been designed in such a way that it does not require a safety connection to electrical earth.

 <p>The lightning flash with arrowhead within an equilateral triangle is intended to alert the user to the presence of uninsulated "dangerous voltage" within the product's enclosure that may be of sufficient magnitude to constitute a risk of electric shock.</p>	<p style="text-align: center;">CAUTION</p> <p style="text-align: center;">RISK OF ELECTRIC SHOCK DO NOT OPEN</p> <p>CAUTION: TO PREVENT RISK OF ELECTRIC SHOCK, DO NOT REMOVE COVER (OR BACK). NO USER-SERVICEABLE PARTS INSIDE. REFER SERVICING TO QUALIFIED SERVICE PROFESSIONAL.</p>	 <p>The exclamation point within an equilateral triangle is intended to alert the user to the presence of important operating and maintenance (servicing) instructions in the literature accompanying the appliance.</p>
--	--	---

Warning: To reduce the risk of fire or electrical shock, do not exposed the apparatus to rain or moisture. No naked flame sources such as candles shall be placed on top of the apparatus.

Caution: Changes or modifications not expressly approved by the manufacturer could void the user's authority to operate this device. Usage of controls or adjustments or performance of procedures other than those specified herein may result in hazardous exposure.

SPECIFICATIONS

Power Supply: AC Adaptor: 100-240V, 50-60Hz
 DC-12V/1.0A

RCA Output Freq. Range: 20-20 KHZ

Max Power Consumption For Adaptor: 6W

Included:..... Turntable, Dust Cover,
 Turntable Operation Sheet,
 Instruction Manual, CD
 Software, 45 RPM Adaptor
 Turntable Rubber Mat,
 12V/1.0A Switching Power
 Supply, USB Output Cable

Unit Size: 15.35" x 13" x 3.15"
 390mm x 330mm x 80mm

Unit Weight: 5.77 lbs (2.62 kg)

Needle Model Number: ITNP-LD1

Design and specifications are subject to change without notice.

TURNTABLE LAYOUT

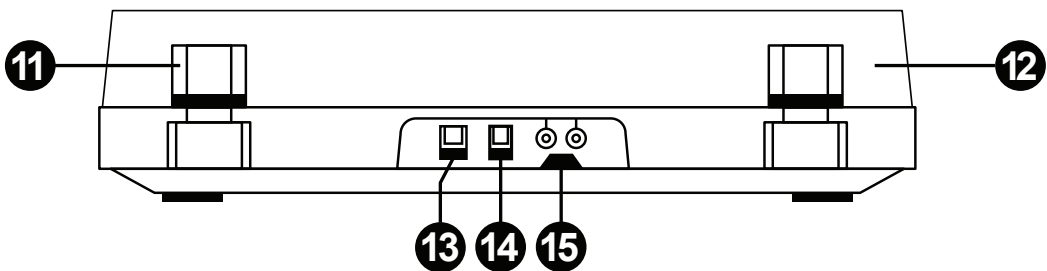
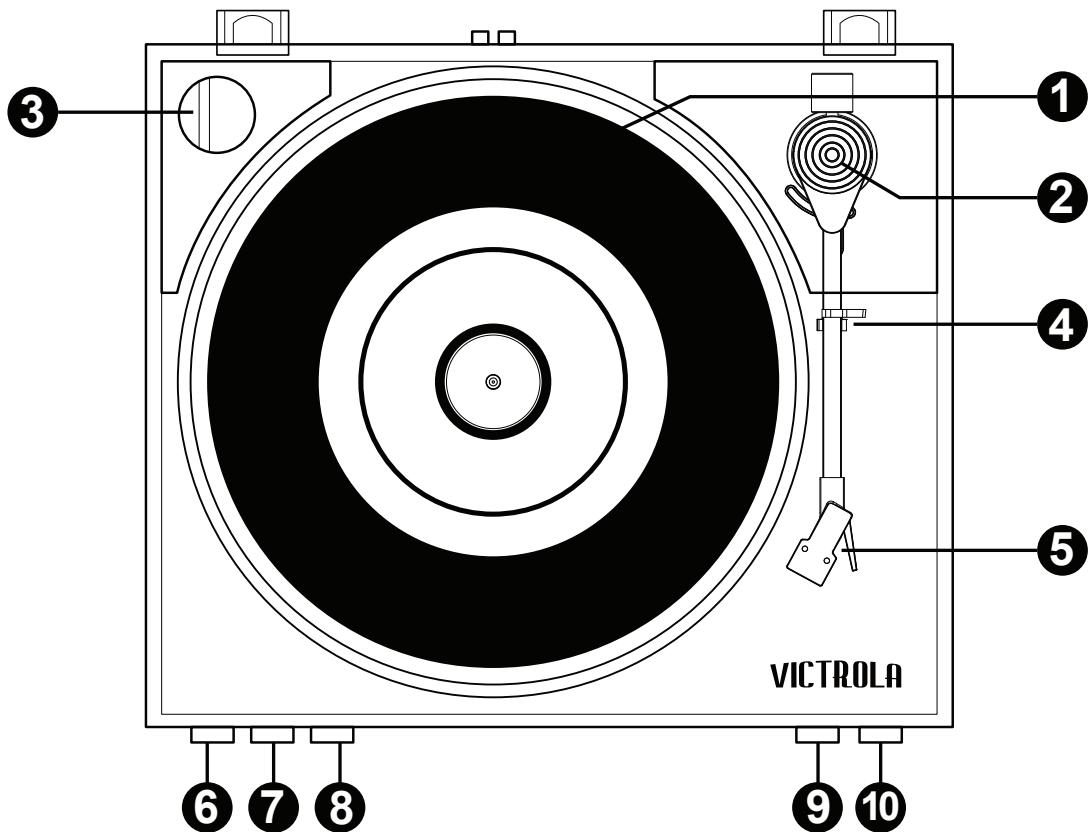

- | | |
|--|--|
| <ul style="list-style-type: none"> 1. Turntable Platter 2. Tone Arm 3. 45 RPM Adaptor 4. Tone Arm Lock 5. Phono Stylus Cartridge 6. Power Button 7. Speed Change Button 8. Start / Stop Button | <ul style="list-style-type: none"> 9. Tone Arm Return Button (Eject) 10. Tone Arm Lift Lever () 11. Dust Cover Hinges 12. Dust Cover 13. USB Output Jack 14. Power Adaptor Jack 15. RCA Output Jack. |
|--|--|

ASSEMBLY OF THE DUST COVER

1. Remove protective plastic film from the DUST COVER.
2. Align the DUST COVER (#12) to the DUST COVER HINGES (#11), on the back of the unit. Then, push down the dust cover gently to clip into the hinges.

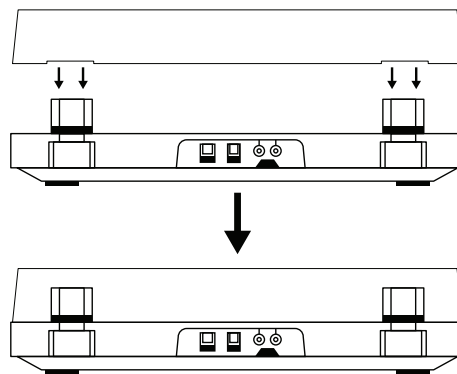

TURNTABLE OPERATION



SET UP

An AC/DC adaptor with an output of 12V/1.0A is included with the USB Turntable. This adaptor is required for operating the unit.

1. Connect the external Hi-Fi Amplifier or Speaker System using RCA Cables (Not Included). *NOTE: The RCA Cables are color coded, the red cable is plugged into a red jack on both the unit and external device (white cable into the white jacks).*
2. Firmly and securely insert the DC plug of the adaptor to the DC IN Jack on the back of the unit.
3. Plug the adaptor's AC plugs into a power outlet rated at 120V AC ~ 60Hz.

BASIC OPERATION

Before use, be sure to remove the white stylus guard off of the needle. Always make sure that the tone arm is unlocked and free to move across the record while operating. Lock the tone arm in place again when it is not in use.

1. Push the POWER Button on the unit to turn the turntable ON.
2. Place a record on the TURNTABLE PLATTER and select the desired speed (33 1/3 / 45) by pushing the SPEED SELECTION SWITCH to the speed according to the type of record.
NOTE: When playing a 45 rpm record, use the included 45 rpm adaptor located inside the accessories bag.
3. Press the START / STOP Button to Start the Turntable. Pushing this button again will Stop (Pause) the Record.
4. Open the TONE ARM CLIP to release the TONE ARM. Push the TONE ARM LIFT LEVER Button ( ) to raise the arm. Gently move the tone arm to the desired position over the record. The turntable will begin to spin only when the tone arm is moved toward the record. To begin playing, push the LIFT LEVER Button again to lower the arm slowly onto the desired position of the record.
5. To return the Tone Arm at any time press and hold (for 1-2 seconds) the RETURN Button. This will automatically return the Tone Arm to the Tone Arm Holder and will Automatically stop the record from playing.

PLEASE NOTE: The Auto Return will automatically return the Tone Arm to the Holder once it has reached the end of the record.

6. To select the volume level, use your external device to adjust the volume.

AUTO RETURN RESET

It is recommended to reset the Auto Return when you move this product. The mechanism of Auto Return will rotate irregularly when moving and it will cause the malfunction of Auto Return. The following steps will reset the Auto Return.

1. Place a record on the platter and play it (Follow the Operation Steps above).
2. Manually place the Tone Arm to the blank part at the end of the record and let it finish playing.
3. The mechanism of Auto Return function will adjust itself properly, then the tone arm will automatically return to the arm rest.

HOW TO REPLACE THE TURNTABLE NEEDLE (*Replacement Needle # ITNP-LD1*)

Removing the Stylus from the Cartridge

1. Set a screwdriver at the tip of the stylus and push down to the direction "A".

WARNING: When applying force to stylus, too much may damage or break the stylus.

2. Pull the stylus out toward the direction "B".

Installing the Stylus

1. Hold the tip of the stylus and insert the other edge by pressing toward direction "C".
2. Push the stylus up toward direction "D" until it locks at the tip.

Caution:

- Do not remove or bend the stylus needle.
- Do not touch the needle to avoid injury to your hand.
- Turn off the unit's power before you replace the stylus.
- Keep out of reach of children.

Please note: *The stylus should last about 300 hours under normal use. It is recommended that the stylus be replaced as soon as you notice a change in sound quality.*

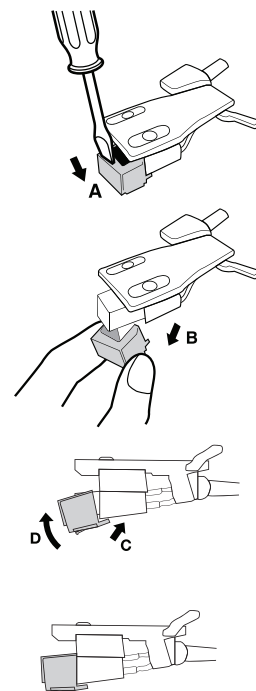

IF THE BELT BECOMES LOOSE

The belt and turntable platter have been installed properly during production, but the belt may have become loose during transportation. If so, follow the below procedures to re install the belt drive:

1. Remove the rubber mat from the turntable platter and carefully unclip the small E ring from the turntable shaft (using tweezers or pliers), Then release the turntable platter from the shaft.
2. Put the drive belt on the inner rim of the turntable platter and pull it through the hole on the platter as shown in the drawing.
3. Hold the belt with your fingers and place the belt onto the motor pulley as shown in the drawing.
4. Clip the E ring on the shaft and place the rubber mat onto the turntable platter.

Caution: Make sure that the drive belt is not twisted or distorted. Avoid oil. Oil splashes will make the belt slippery.

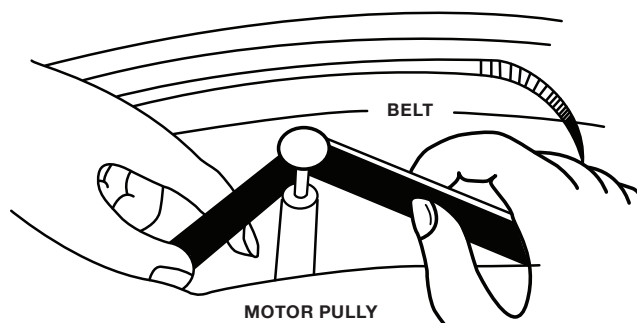

TIPS FOR BETTER TURNTABLE USE

1. When opening or closing the turntable cover, handle it gently, gripping it either at the center or at each side.
2. Do not touch the needle tip with your fingers; avoid bumping the needle against the turntable platter or record edge.
3. Frequently clean the needle tip, using a soft brush in a “back-to-front” motion.
4. If you must use a needle cleaning fluid, use very sparingly.
5. Gently wipe the dust cover and turntable housing with a soft cloth. Use only a small amount of mild detergent to clean the turntable and dust cover.
6. Never apply harsh chemicals or solvents to any part of the turntable system.

USB RECORDING OPERATION

To properly record your vinyl to MP3 via computer, use the included USB Output Cable and Instructional CD Software. Connect one end of the USB cable to the turntable and the other end into your computer. Then connect the AC power cord to the turntable. To install and use the software on your computer, select the proper Mac or PC install files, then follow the prompts provided on the Instructional CD.

For the most up to date manuals, software, instructional details, troubleshooting or other downloadable content, please go to <http://audacityteam.org>.

FCC STATEMENT

This device complies with part 15 of the FCC Rules. Operation is subject to the following two conditions: (1) this device may not cause harmful interference, and (2) this device must accept any interference received, including interference that may cause undesired operation.

Changes or modifications not expressly approved by the party responsible for compliance could void the user's authority to operate the equipment.

NOTE: This equipment has been tested and found to comply with the limits for a Class B digital device, pursuant to Part 15 of the FCC Rules. These limits are designed to provide reasonable protection against harmful interference in a residential installation. This equipment generates, uses and can radiate radio frequency energy and, if not installed and used in accordance with the instructions, may cause harmful interference to radio communications. However, there is no guarantee that interference will not occur in a particular installation. If this equipment does cause harmful interference to radio or television reception, which can be determined by turning the equipment off and on, the user is encouraged to try to correct the interference by one or more of the following measures:

- Reorient or relocate the receiving antenna.
- Increase the separation between the equipment and receiver.
- Connect the equipment into an outlet on a circuit different from that to which the receiver is connected.
- Consult the dealer or an experienced radio/TV technician for help

CALIFORNIA PROP 65 WARNING



WARNING: This product can expose you to chemicals including lead, which is known to the State of California to cause cancer. For more information go to www.P65Warnings.ca.gov.

WARRANTY

Victrola is a registered trademark of Innovative Technology Electronics LLC.

Innovative Technology Electronics LLC.

Limited Warranty: 90 Days Labor, One Year Parts

Innovative Technology Electronics LLC. (IT) warrants the product to be free from "Defects" in materials under normal use for a period of "One Year" from the date of the original purchase. The Warranty is "Not" transferable. IT agrees, within the initial "90 Day" period, to repair or replace the product if it is determined to be defective at "No Charge". It is further agreed that IT will cover the cost to repair or replace damaged "Parts" only for a total period of "One Year" from the date of the original purchase. The warranty does not cover cosmetic damage, antennas, AC cords, cabinets, headbands, ear-pads, or damage due to line power surges, connection to improper voltage supply or settings, misuse, mishandling, accident, acts of God or attempted repair by an unauthorized service agent.

To obtain service, the purchaser MUST present an original sales receipt / proof of purchase. Please contact us at www.victrola.com to request an RMA (Return Material Authorization) number to return products for service or replacement. Returns without an RMA number on the package will be refused and returned to sender. Upon receipt of the returning item and our full inspection (IT) may issue a replacement to customer for the same item or of one that has equivalent value and features. To return an item, supply full name, return address, phone number, item purchased, receipt of purchase and reason for return to obtain RMA number.

All returns must be in the original packaging or reasonable substitute to prevent damage. Customer "Must" include full name, shipping address and telephone number inside of package. No return will be shipped back to a PO Box or APO address.

Please include your check or money order in the amount of:

- **USD \$5.00 for items \$10.00 to \$39.99 (Price Paid Per Unit)**
- **USD \$10.00 for items \$40.00 to \$99.99 (Price Paid Per Unit)**
- **USD \$16.00 for items \$100.00 and up (Price Paid Per Unit)**
- **Shipping fees are non-refundable**

to be payable to Innovative Technology Electronics LLC. (for handling and return shipping charges) (IT) will not be responsible for delays or unprocessed claims resulting from a purchaser's failure to provide any / all of the necessary information. Send all inquiries or RMA request via our website **www.victrola.com/pages/technical-support**.

Innovative Technology Electronics LLC.

1 Channel Drive

Port Washington, NY 11050

Toll free: 1-877-483-2497

Website for support: www.victrola.com/pages/technical-support

There are no express warranties except as listed above.

REPAIR OR REPLACEMENT AS PROVIDED UNDER THIS WARRANTY IS THE EXCLUSIVE REMEDY OF THE CUSTOMER, (IT) SHALL NOT BE LIABLE FOR ANY INCIDENTAL OR CONSEQUENTIAL DAMAGES FOR BREACH OF ANY EXPRESS OR IMPLIED WARRANTY ON THIS PRODUCT EXCEPT TO THE EXTENT PROHIBITED BY APPLICABLE LAW. ANY IMPLIED WARRANTY OF MERCHANTABILITY OR FITNESS FOR A PARTICULAR PURPOSE ON THIS PRODUCT IS LIMITED IN DURATION TO THE DURATION OF THIS WARRANTY.

Some states do not allow the exclusion or limitation of incidental or consequential damages, or limitations on how long an implied warranty lasts, so the above exclusions or limitations may not apply to you. This warranty gives you specific legal rights and you may also have other rights, which vary from state to state.

Made In China.