

MOULINEX

**FOUR A POSER
OX2838**

Moulinex®

FR

EN

NL

IT

ES

PT



Delicio 39L Oven

www.moulinex.com

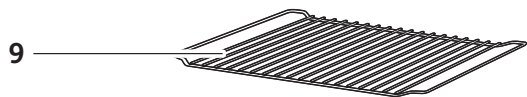
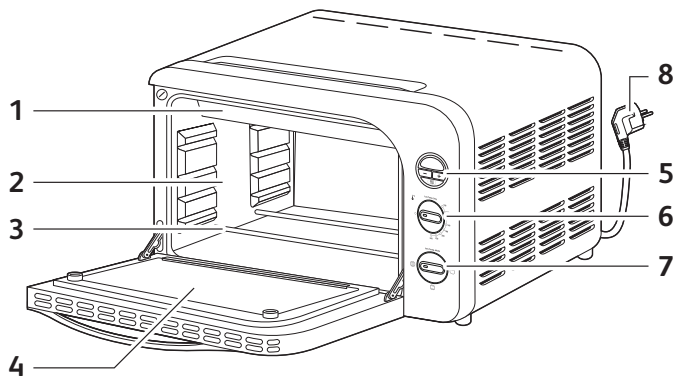

DESCRIPTION

- 1 Éléments chauffants supérieurs
- 2 Parois anti-adhésives
- 3 Éléments chauffants inférieurs
- 4 Porte triple-parois verre
- 5 Ecran digital avec rétroéclairage
- 6 Bouton de réglage température
- 7 Bouton de sélection des fonctions
- 8 Cordon d'alimentation
- 9 Grille réversible
- 10 Plat lèche-frite

DESCRIPTION

- 1 Upper heating elements
- 2 Non-stick walls
- 3 Lower heating elements
- 4 Triple-walled glass door
- 5 Digital display
- 6 Temperature adjustment button
- 7 Function selection button
- 8 Power cord
- 9 Reversible grill
- 10 Drip tray

BESCHRIJVING

- 1 Bovenste verwarmingselement
- 2 Anti-aanbakwanden
- 3 Onderste verwarmingselement
- 4 Deur met driedubbel glas
- 5 Digitaal scherm met achtergrondverlichting
- 6 Temperatuurregelaar
- 7 Functieknop
- 8 Snoer
- 9 Omkeerbaar rooster
- 10 Opvangbak voor vet

DESCRIZIONE

- 1 Elementi riscaldanti superiori
- 2 Pareti antiaderenti
- 3 Elementi riscaldanti inferiori
- 4 Porta in vetro a tre strati
- 5 Display digitale
- 6 Pulsante di regolazione della temperatura
- 7 Pulsante di selezione della funzione
- 8 Cavo di alimentazione
- 9 Griglia reversibile
- 10 Vassoio raccogliocce

DESCRIPCIÓN

- 1 Resistencias superiores
- 2 Paredes antiadherentes
- 3 Resistencias inferiores
- 4 Puerta de cristal de triple acristalamiento
- 5 Pantalla digital
- 6 Botón de ajuste de temperatura
- 7 Botón de selección de función
- 8 Cable eléctrico
- 9 Grill reversible
- 10 Bandeja recogegotas

DESCRIÇÃO

- 1 Elementos de aquecimento superiores
- 2 Paredes antiaderentes
- 3 Elementos de aquecimento inferiores
- 4 Porta de vidro com parede tripla
- 5 Ecrã digital
- 6 Botão de regulação da temperatura
- 7 Botão de seleção da função
- 8 Cabo de alimentação
- 9 Grelha reversível
- 10 Gaveta de recolha de sucos

1

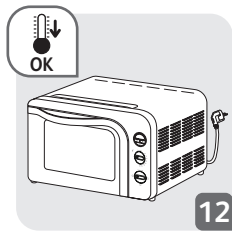
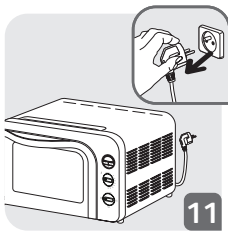
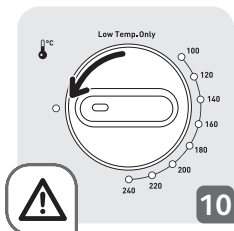
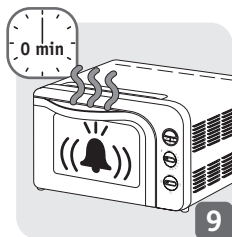
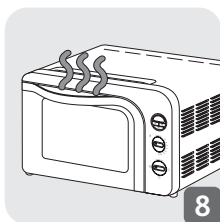
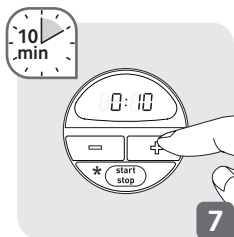
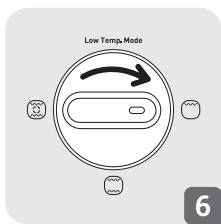
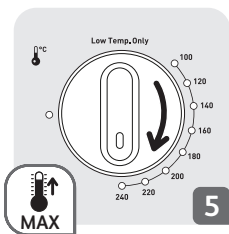
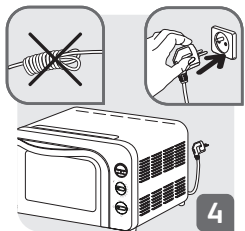
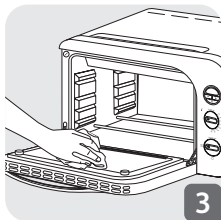
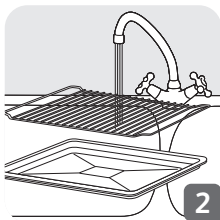
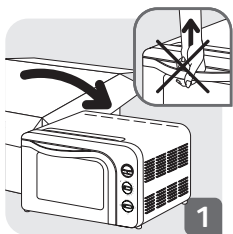

* Marche/Arrêt - Start/Stop - Keuze/Stop - Avvio/Arresto - Iniciar/Detener - Iniciar/parar

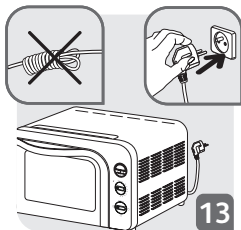

13

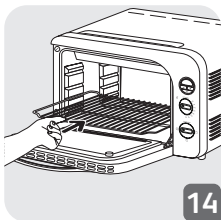

14

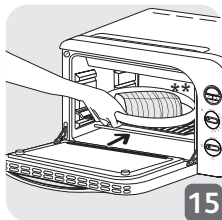

15

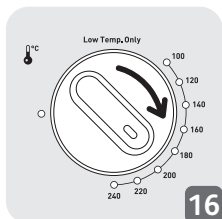

16

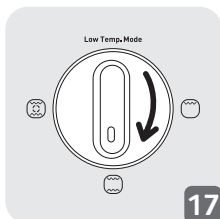

17

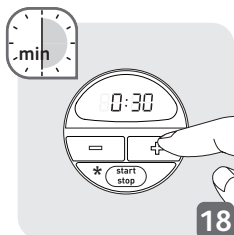

18

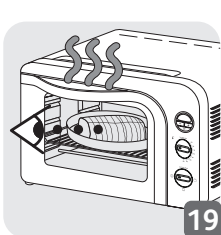

19

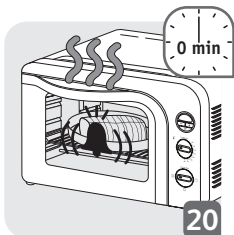

20

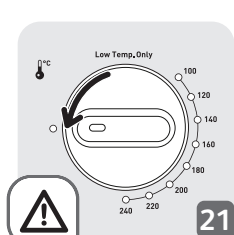

21

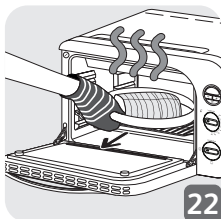

22

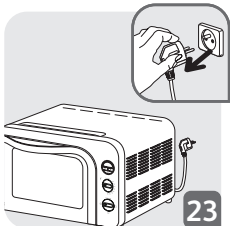

23

- **Plat non fourni avec l'appareil
- **Dish not supplied with the appliance
- **Schaal niet inclusief bij het apparaat
- **Piatto non fornito con l'apparecchio
- **Plato no suministrado con el aparato
- **Prato não fornecido com o aparelho

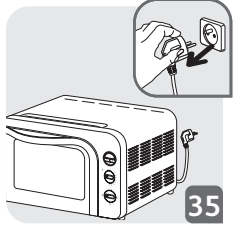
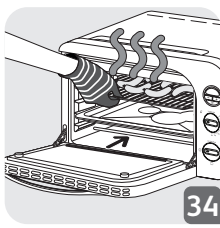
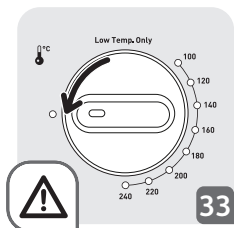
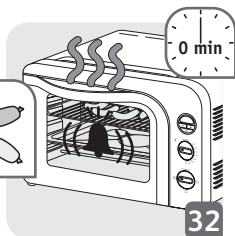
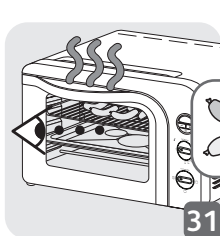
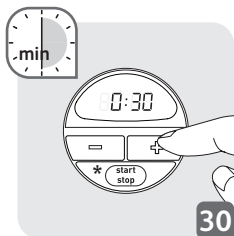
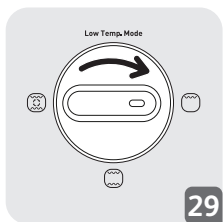
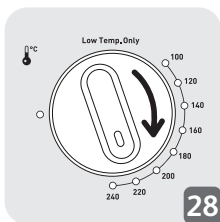
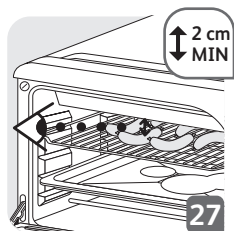
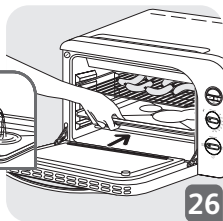
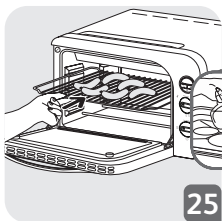
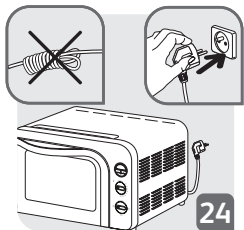

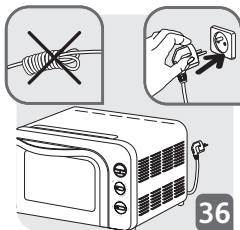

36

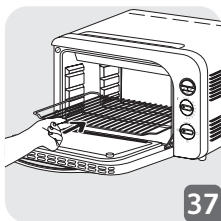

37

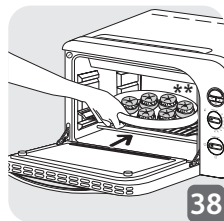

38

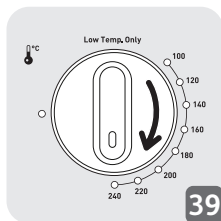

39

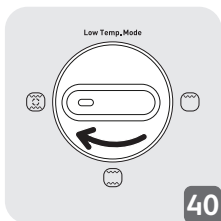

40

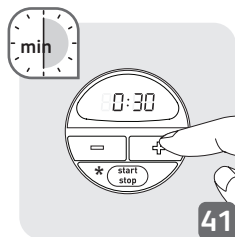

41

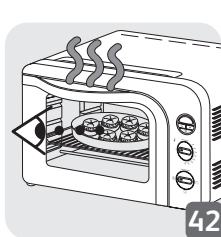

42

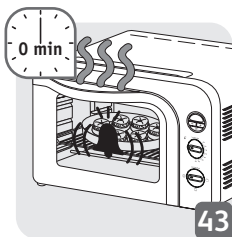

43

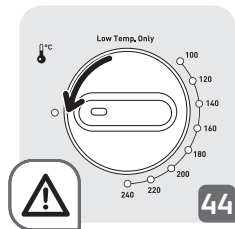

44

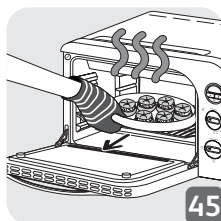

45

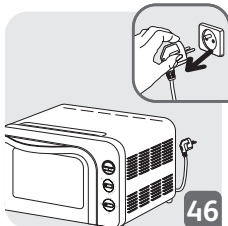

46

- **Plat non fourni avec l'appareil
 **Dish not supplied with the appliance
 **Schaal niet inclusief bij het apparaat
 **Piatto non fornito con l'apparecchio
 **Plato no suministrado con el aparato
 **Prato não fornecido com o aparelho

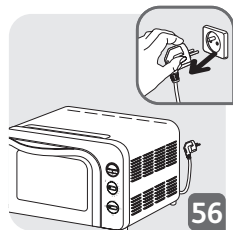
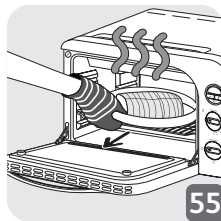
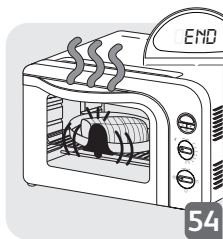
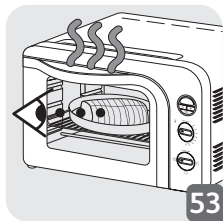
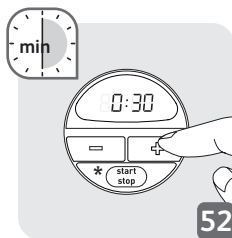
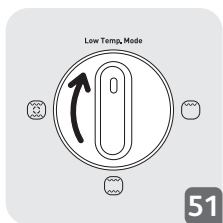
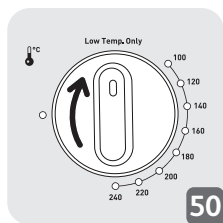
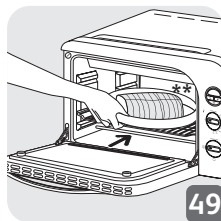
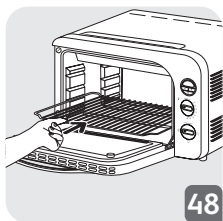
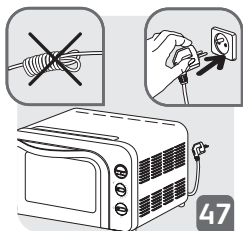

- **Plat non fourni avec l'appareil
- **Dish not supplied with the appliance
- **Schaal niet inclusief bij het apparaat
- **Piatto non fornito con l'apparecchio
- **Plato no suministrado con el aparato
- **Prato não fornecido com o aparelho

Avertissement relatif à la sécurité alimentaire



ATTENTION : les aliments cuits à basse température ne sont pas pasteurisés et peuvent présenter un risque pour certaines personnes, notamment les femmes enceintes, les jeunes enfants, les personnes âgées ou les personnes immunodéprimées.

Sécurité alimentaire

Aliments crus :

Achetez vos aliments crus auprès de sources ou de distributeurs réputés et agréés.

Si ces ingrédients sont détériorés, contaminés par la saleté, décolorés, malodorants et/ou ont mauvais au goût, ne les utilisez pas.

N'oubliez pas de rincer à grande eau les fruits et légumes avant l'utilisation.

Respectez les conditions d'utilisation et de conservation avant l'utilisation de ces ingrédients.

Hygiène :

Pour éviter toute contamination par les équipements et les ustensiles, nettoyez-les avant l'utilisation et mettez-les en contact avec les aliments.

Nettoyez avec une éponge propre et du liquide vaisselle. Rincez-les bien et laissez-les sécher à l'air.

Il est également nécessaire de nettoyer et de désinfecter le plan de travail avant l'utilisation.

En outre, lavez-vous les mains minutieusement et régulièrement pour réduire le risque de contamination.

N'oubliez pas de vous laver les mains avant de commencer à préparer vos aliments, ainsi que pendant la préparation des aliments crus ou sales (ingrédients avec de la terre).

Si vos mains présentent des blessures ou des coupures, assurez-vous de les désinfecter et d'utiliser un pansement approprié avant chaque préparation.

Mangez rapidement les repas préparés lorsqu'ils sont prêts.

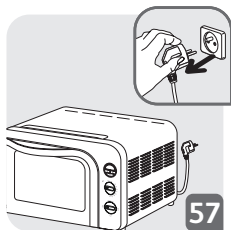

57

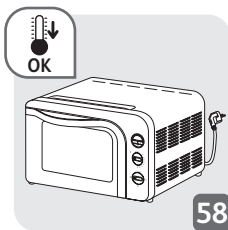

58

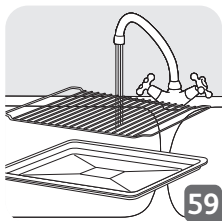

59

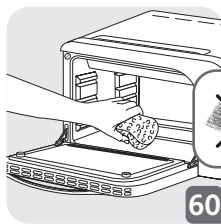

60

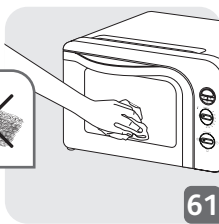

61

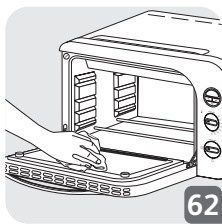

62

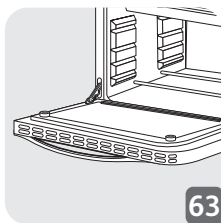

63

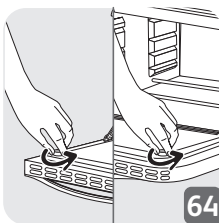

64

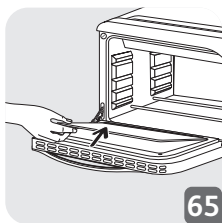

65

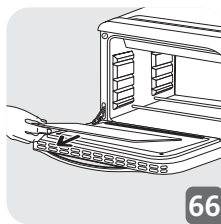

66

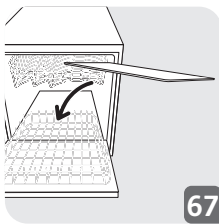

67

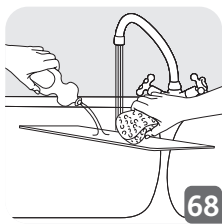

68



| | 230g + 300g | Low Temp. Mode | | 15 min | Low Temp. | *35 |
|--|-------------------|----------------|------|--------|-----------|--------------|
| | 250g x2 | Low Temp. Mode | | 15 min | Low Temp. | *59 |
| | 300g x2 | Low Temp. Mode | | 15 min | Low Temp. | *55 |
| | x4 | | | 10 min | 220 | 25 |
| | 1,5 Kg | | | - | 220 | 90 |
| | 1 Kg | | | 10 min | 240 | 30 |
| | 1 Kg | | | - | 220 | 70 |
| | x 4 | | | - | 240 | 13 +7 |
| | x 12 | | | - | 240 | 16 +6 |
| | 400g | | | 10 min | 220 | 12 |
| | | | | - | 200 | 50 |
| | 600g | | | 10 min | 240 | 23 |
| | | | | - | 220 | 32 |
| | | | | 10 min | 170 | 30 |
| | | | | - | 200 | 37 |

* Toutes les recettes de cuisson à basse température sont adaptées à une cuisson à point.

* All Low temperature cooking recipes are for well done cooking.

* Alle kookrecepten voor lage temperaturen zijn gericht op doorbakken eten.

* Tutte le ricette a bassa temperatura sono per cibi che richiedono un alto grado di cottura.

* Todas las recetas de cocción a baja temperatura son para realizar un cocinado adecuado.

* Todas as receitas de preparação a baixa temperatura são para alimentos bem passados.



ATTENTION : les aliments cuits à basse température ne sont pas pasteurisés et peuvent présenter un risque pour certaines personnes, notamment les femmes enceintes, les jeunes enfants, les personnes âgées ou les personnes immunodéprimées.

CAUTION: foods are not pasteurized under low temperature and may pose a risk to certain individuals. These individuals include pregnant women, young children, the elderly or otherwise immune-compromised.

LET OP: voedingsmiddelen worden niet gepasteuriseerd bij lage temperaturen en kunnen voor sommige mensen een risico vormen.
Dit omvat zwangere vrouwen, jonge kinderen, ouderen of anderen met een aangetast immuunsysteem.

ATTENZIONE: gli alimenti non vengono pastorizzati a bassa temperatura e possono rappresentare un rischio per alcune categorie di persone.
Queste categorie includono donne in stato di gravidanza, bambini, anziani o soggetti immunodepressi.

PRECAUCIÓN: Los alimentos no se pasteurizan a baja temperatura y pueden suponer un riesgo para determinadas personas.
Entre estas personas se incluyen mujeres embarazadas, niños pequeños, ancianos u otras personas con problemas inmunológicos.

CUIDADO: os alimentos não são pasteurizados a baixas temperaturas e podem representar um risco para determinadas pessoas.
Estas pessoas incluem mulheres grávidas, crianças, idosos ou pessoas com um sistema imunitário comprometido.

