

FR

EN

DE

NL

IT

ES

PT

EL

AR

FA

ZH

MS

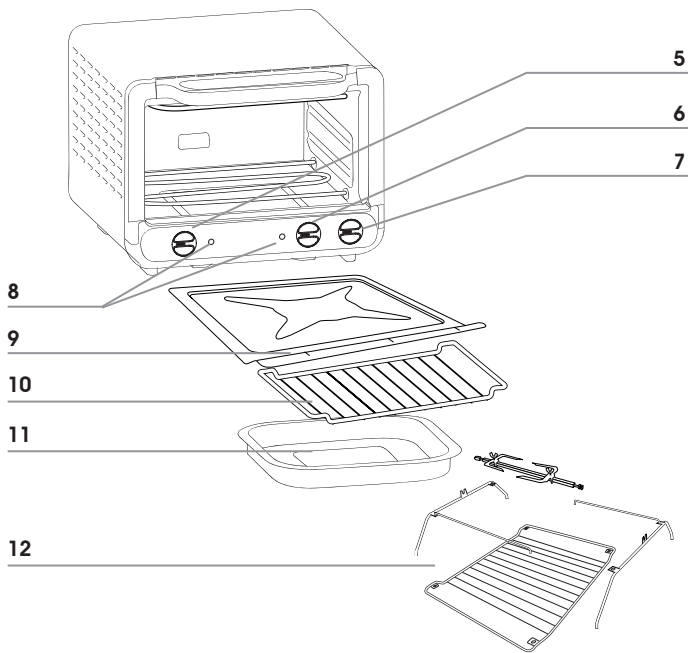
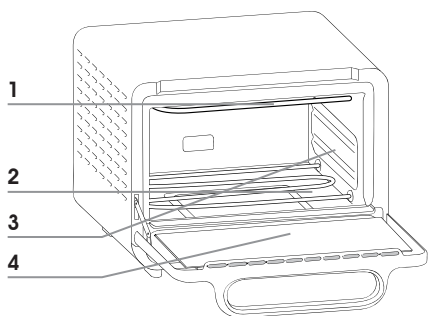

## DESCRIPTION

1. Résistance supérieure
2. Résistance inférieure
3. Parois non stick
4. Porte double parois
5. Bouton des fonctions
6. Bouton de réglage température
7. Bouton de minuterie
8. Voyants de fonctionnement
9. Sole ramasse miettes
10. Grille réversible
11. Plat non adhésif
12. Kit tournebroche (1 grille, 2 fourches, 2 supports broche, 1 tige, 1 plat)

## DESCRIPTION

1. Top heating element
2. Bottom heating element
3. Non-stick walls
4. Double-wall door
5. Function buttons
6. Temperature control button
7. Timer button
8. Power indicator lights
9. Crumb tray
10. Reversible shelf
11. Non-stick oven tray
12. Rotisserie kit (1 grill, 2 forks, 2 meat holders, 1 spit rod, 1 plate)

## BESCHREIBUNG

1. Oberes Heizelement
2. Unteres Heizelement
3. Antihaftbeschichtete Wände
4. Doppelwandige Tür
5. Funktionsknöpfe
6. Temperaturregler
7. Timer-Knopf
8. Betriebsleuchten
9. Krümelblech
10. Umkehrbarer Rost
11. Antihaffbeschichtete Backform
12. Drehspieß-Set (1 Rost, 2 Gabeln, 2 Spießhalterungen, 1 Spieß, 1 Schale)

## BESCHRIJVING

1. Bovenste verwarmingselement
2. Onderste verwarmingselement
3. Anti-aanbakwanden
4. Dubbelwandige deur
5. Functieknoppen
6. Temperatuurregelknop
7. Timerknop
8. Aan/uit-controlelampjes
9. Kruimellade
10. Omkeerbaar rooster
11. Anti-aanbakovenschaal
12. Draaispitset ( 1 rooster, 2 vorken, 2 spithouders, 1 stang, 1 schaal)

## DESCRIPCIÓN

1. Resistencia superior
2. Resistencia inferior
3. Paredes antiadherentes
4. Puerta de doble cristal
5. Botones de funciones
6. Botón de ajuste de temperatura
7. Botón de temporizador
8. Pilotos de funcionamiento
9. Bandeja recogemigas
10. Rejilla reversible
11. Fuente antiadherente
12. Kit de asador (1 rejilla, 2 tenedores, 2 soportes para brocheta, 1 varilla, 1 fuente)

## DESCRIPTION

1. Resistência superior
2. Resistência inferior
3. Paredes antiaderentes
4. Porta de parede dupla
5. Botões das funções
6. Botão de regulação da temperatura
7. Botão temporizador
8. Indicadores de funcionamento
9. Bandeja para migalhas
10. Grelha reversível
11. Prato não aderente
12. Kit espeto rotativo (1 grelha, 2 forquilhas, 2 suportes para espeto, 1 haste, 1 prato)

## DESCRIZIONE

1. Resistenza superiore
2. Resistenza inferiore
3. Pareti anti-adesive
4. Sportello a parete doppia
5. Pulsanti delle funzioni
6. Manopola di regolazione della temperatura
7. Manopola del timer
8. Spie di funzionamento
9. Fondo raccogli-briciole
10. Griglia reversibile
11. Piatto non adesivo
12. Kit girarrosto (1 griglia, 2 forcelle, 2 supporti per spiedo, 1 asta, 1 piatto)

الوصف

1. مقاومة أعلى
2. مقاومة أدنى
3. جدار غير لاصق
4. باب بجدار مزدوج
5. زر التشغيل
6. زر تعديل الحرارة
7. زر التوقيت
8. أضواء التشغيل
9. أرضية لجمع الفتات
10. شواية تعمل بالاتجاهين
11. طبق مقاوم للسخن
12. عدة الشواية (1 قلاية, 2 شوكة, 2 دعامة لسيخ الشواء, 1 ذراع, 1 طبق

## περιγραφή

1. Αντίσταση στο επάνω μέρος
2. Αντίσταση στο κάτω μέρος
3. Αντικολλητικοί τοίχοι
4. Διπλής αντοχής πόρτα
5. Κουμπιά λειτουργιών
6. Κουμπιέ θερμοκρασίας
7. Χρονόμετρο
8. Φωτεινή ένδειξη λειτουργίας
9. Ψιχουλοσυλλέκτης
10. Ράφι διπλής όψης
11. Αντικολλητικός δίσκος
12. Kit περιστρεφόμενης σούβλας (1 εσχάρα, 2 διχάλες, 2 στηρίγματα σούβλας, 1 σούβλα, 1 ταψί)

- شرح
1. استحکام عالی
  2. مقاومت کمتر
  3. دیواره نجسب
  4. دیواره دو جداره
  5. دکمه انتخاب عملکردها
  6. دکمه تنظیم دما
  7. دکمه زمان سنج
  8. نشانگرهای عملکرد
  9. دارای اشغال جمع کن
  10. توری برگشت پذير
  11. سطح نجسب
  12. کیت کباب/پريان کردن (1 عدد توری, 2 عدد چنگال, 2 عدد گیره نگهدارنده, 1 عدد میله گردان, 1 عدد بشقاب

## 說明

1. 頂部加熱元件
2. 底部加熱元件
3. 不沾壁
4. 雙層門
5. 功能按鈕
6. 溫度控制鈕
7. 計時按鈕
8. 電源指示燈
9. 麵包屑盤
10. 翻轉式層架
11. 不沾爐盤
12. 烤肉用具 (1 個烤架, 2 支烤肉叉, 2 個烤肉固定架, 1 支烤肉夾棍, 1 個烤盤)

## PENERANGAN

1. Elemen pemanas atas
2. Elemen pemanas bawah
3. Dinding tak melekat
4. Pintu dinding berganda
5. Butang fungsi
6. Butang kawalan suhu
7. Butang pemasa
8. Cahaya penunjuk kuasa
9. Dulang serdak
10. Rak boleh terbalikkan
11. Dulang ketuhar tak melekat
12. Rotisserie kit (1 gril, 2 garpu, 2 pemegang daging, 1 batang bercabang, 1 pinggan)

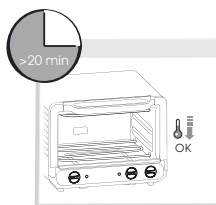
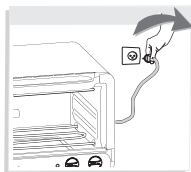
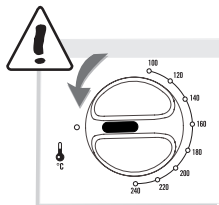
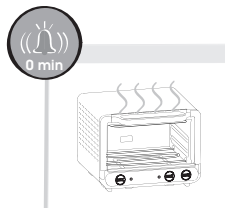
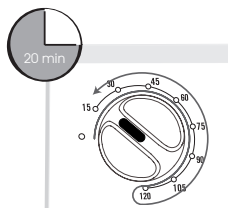
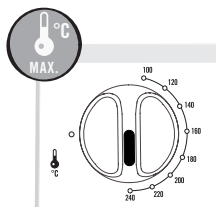
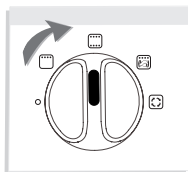
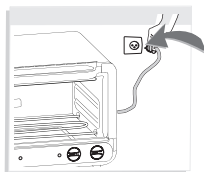
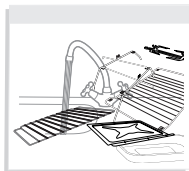
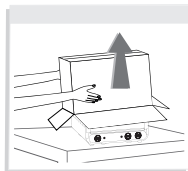
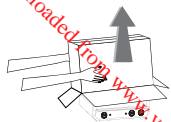

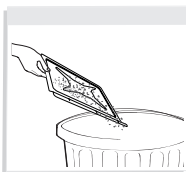
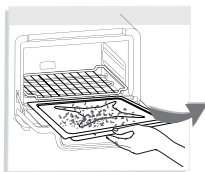

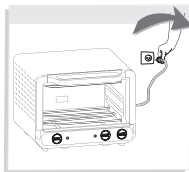
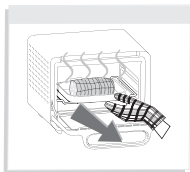
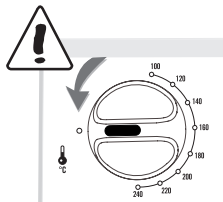
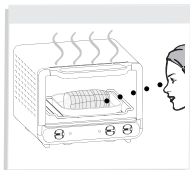
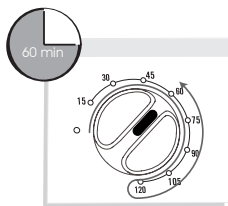
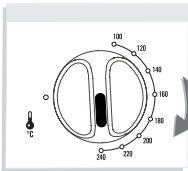
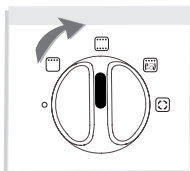
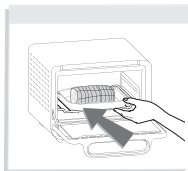
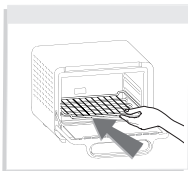
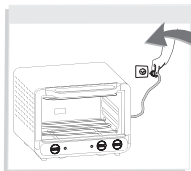

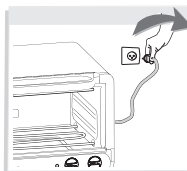
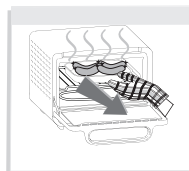
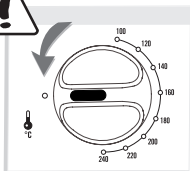
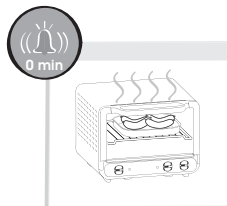
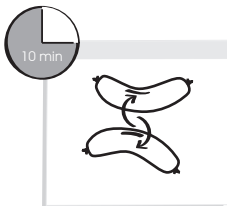
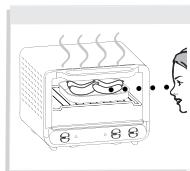
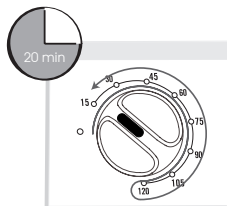
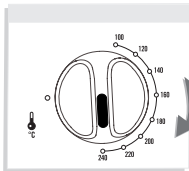
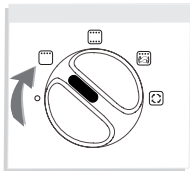
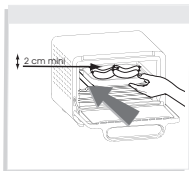
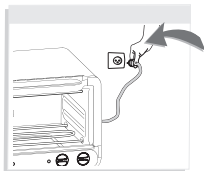



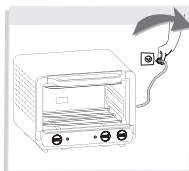
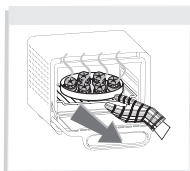
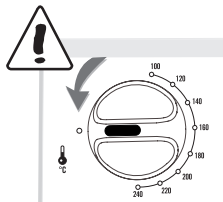
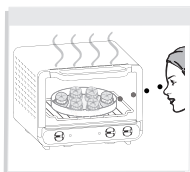
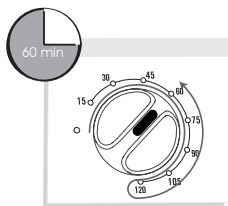
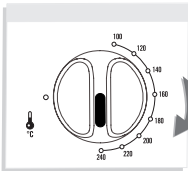
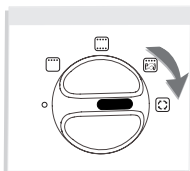
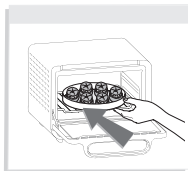
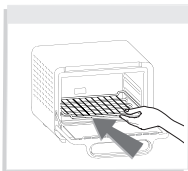
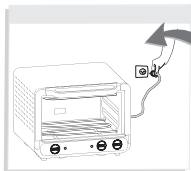

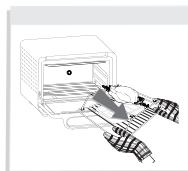
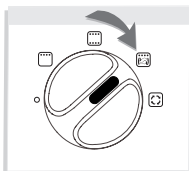
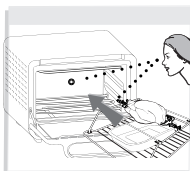
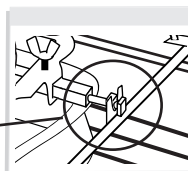
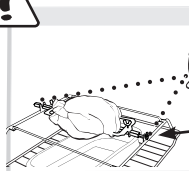
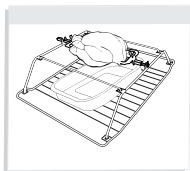
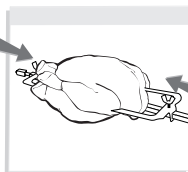
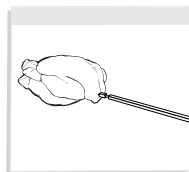
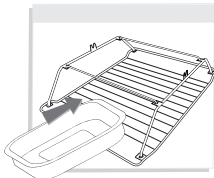
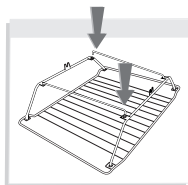
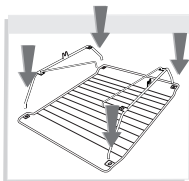
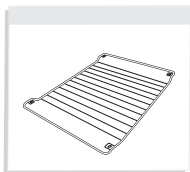

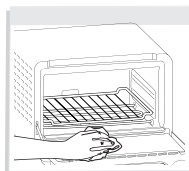
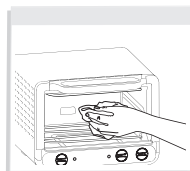
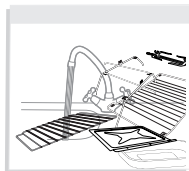
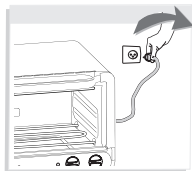



				Préchauffage Preheat	
			°C		min.
		4	240	10 min	20 min
		3	220	-	70 min
		-	-	-	80 min
		4	240	10 min	20 min
		5	240	-	80 min
		8	-	10 min	16 + 6 min
		8	-	5 min	12 + 8 min
		4	240	-	28 min
		2	240	5 min	55 min
		3	220	10 min	25 min
		4	240	-	30 min
		3	180	10 min	50 min
		4	180	10 min	25 min

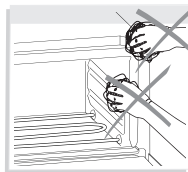
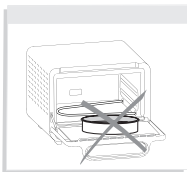
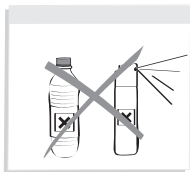
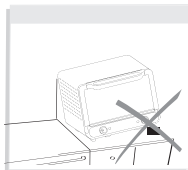
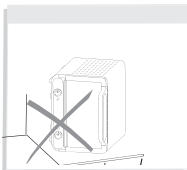
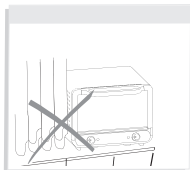
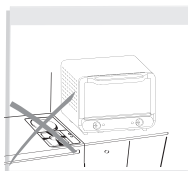
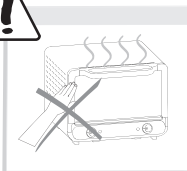
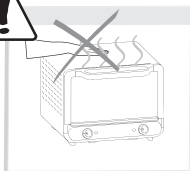
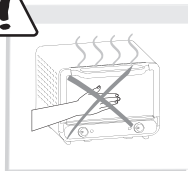
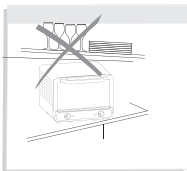
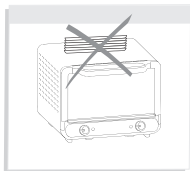





			
<b>ALGERIA</b>	GRUPE SEB EXPORT Chemin du Petit Bois, Les 4M 69130 ECULLY - FRANCE	<b>213-41 28 18 53</b>	1 year
<b>ARGENTINA</b>	GRUPE SEB ARGENTINA S.A. Billinghurst 1833 3° C1425DTK Capital Federal Buenos Aires	<b>0800-122-2732</b>	2 años
<b>ՀԱՅԱՍՏԱՆ ARMENIA</b>	«Գերազգիա ՄեԲ-Կոստոկ»ՓԲԸ, 119180 Մոսկվա, Ռուսաստան Ստարոմոնետնի քրք., տ. 14, շ. 2	<b>(010) 55-76-07</b>	2 տարի/ years
<b>AUSTRALIA</b>	GRUPE SEB AUSTRALIA PO Box 7535, Silverwater NSW 2128	<b>02 97487944</b>	1 year
<b>ÖSTERREICH</b>	SEB ÖSTERREICH HmbH Campus 21 - Businesspark Wien Süd Liebermannstr. A02 702 2345 Brunn am Gebirge	<b>01 866 70 299 00</b>	2 Jahre
<b>BELGIQUE / BELGIE</b>	GRUPE SEB BELGIUM SA NV 25 avenue de l'Espérance - ZI 6220 Fleurus	<b>32 70 23 31 59</b>	2 ans / years
<b>БЕЛАРУСЬ / BELARUS</b>	ЗАО «Група СЕБ-Восток», 119180 Москва, Россия Старомонетный пер. д. 14 стр.2	<b>017 2239290</b>	2 года/ years
<b>BOSNA I HERCEGOVINA</b>	SEB Développement Predstavništvo u BiH Vrazova 8/II 71000 Sarajevo	<b>Info-linija za potrošače 033 551 220</b>	2 godine
<b>BRASIL</b>	GRUPO SEB DO BRASIL PRODUTOS DOMESTICOS LTDA Avenida Arno, 146 Mooca 03108-900 São Paulo SP	<b>0800-119933</b>	1 ano
<b>БЪЛГАРИЯ/ BULGARIA</b>	ГРУП СЕБ БЪЛГАРИЯ ЕООД Ул. Борово 52 Г, ет. 1, офис 1, 1680 София	<b>0700 10 330</b>	2 ГОДИНИ
<b>CANADA</b>	GRUPE SEB CANADA 345 Passmore Avenue Toronto, ON M1V 3N8	<b>1-800-418-3325</b>	1 year
<b>CHILE</b>	GRUPE SEB CHILE Comercial Ltda Avda. Nueva Los Leones 0252 Providencia, Santiago	<b>+56 2 232 77 22</b>	2 años
<b>COLOMBIA</b>	GRUPE SEB COLOMBIA Apartado Aereo 172, Kilometro 1 Via Zipaquirá Cajica Cundinamarca	<b>18000919288</b>	2 años
<b>HRVATSKA Croatia</b>	SEB Développement S.A.S. Vodnjanska 26 10000 Zagreb	<b>01 30 15 294</b>	2 godine
<b>ČESKÁ REPUBLIK / CZECH REPUBLIC</b>	GRUPE SEB ČR spol. s r. o. Jankovcova 1569/2c 170 00 Praha 7	<b>731 010 111</b>	2 roky
<b>DANMARK</b>	GRUPE SEB NORDIC AS Tempovej 27 2750 Ballerup	<b>44 663 155</b>	2 år
<b>DEUTSCHLAND</b>	GRUPE SEB DEUTSCHLAND GmbH / KRUPS GmbH Herrrainweg 5 63067 Offenbach	<b>0212 387 400</b>	2 Jahre

			
<b>EESTI/ ESTONIA</b>	GRUPE SEB POLSKA SP Z O.O. ul. Ostrobramska 79 04-175 Warszawa	<b>5 800 3777</b>	2 aastat
<b>SUOMI / FINLAND</b>	Groupe SEB Finland Kutojantie 7 02630 Espoo	<b>09 622 94 20</b>	2 Vuotta
<b>FRANCE</b> Inclus Martinique, Guadeloupe, Réunion & St. Martin	GRUPE SEB France SAS Place Ambroise Courtois 69355 Lyon Cedex 08	<b>09 74 50 47 74</b>	1 an
<b>GREECE / ΕΛΛΑΔΑ</b>	SEB GROUPE ΕΛΛΑΔΟΣ Α.Ε. Οδός Φραγκοκκλησιάς 7 Τ.Κ. 151 25 Παράδεισος Αμαρουσίου	<b>2106371251</b>	2 χρόνια
<b>HONG KONG</b>	SEB ASIA Ltd. Room 901, 9/F, North Block, Skyway House 3 Sham Mong Road, Tai Kok Tsui, Kowloon	<b>852 8130 8998</b>	1 year
<b>MAGYARORSZAG/ Hungary</b>	GRUPE SEB CENTRAL-EUROPE Kft. Tavíro köz 4 2040 Budaörs	<b>(1) 8018434</b>	2 év
<b>INDONESIA</b>	Groupe SEB Indonesia (Representative office) Sudirman Plaza, Plaza Marein 8th Floor JL Jendral Sudirman Kav 76-78, Jakarta 12910, Indonesia	<b>+62 21 5793 6881</b>	1 year
<b>ITALIA</b>	GRUPE SEB ITALIA S.p.A. Via Montefeltro, 4 20156 Milano	<b>199207354</b>	2 anni
<b>JAPAN</b>	GRUPE SEB JAPAN Co. Ltd. 1F Takanawa Muse Building, 3-14-13, Higashi Gotanda, Shinagawa-Ku, Tokyo 141-0022	<b>0570-077772</b>	1 year
<b>ҚАЗАҚСТАН KAZAKHSTAN</b>	«Группа СЕБ-Восток» ЖАҚ, 119180 Мәскеу, Ресей Старомонетный түйық көш, 14-үй, 2-құрылыс	<b>727 378 39 39</b>	2 жыл / years
<b>KOREA</b>	(유)그룹 세브 코리아 서울시 종로구 서린동 88 서린빌딩 3층 110-790	<b>1588-1588</b>	1 year
<b>LATVJA / LATVIA</b>	GRUPE SEB POLSKA SP Z O.O. ul. Ostrobramska 79 04-175 Warszawa	<b>6 716 2007</b>	2 gadi
<b>LIETUVA/ LITHUANIA</b>	GRUPE SEB POLSKA SP Z O.O. ul. Ostrobramska 79 04-175 Warszawa	<b>6 470 8888</b>	2 metai
<b>MACEDONIA</b>	Groupe SEB Bulgaria EOOD Office 1, floor 1, 52G Borovo St., 1680 Sofia - Bulgaria ГРУП СЕБ БЪЛГАРИЯ ДООЕЛ Ул. Борово 52 Г, сп. 1, офис 1, 1680 София, България	<b>(0)2 20 50 022</b>	2 години / years
<b>MALAYSIA</b>	GRUPE SEB MALAYSIA SDN. BHD Lot No.C/3A/001 & 002, Block C, Kelana Sq. No.17, Jalan SS7/26, 47301 Kelana Jaya Petaling Jaya, Selangor	<b>65 6550 8900</b>	1 year
<b>MEXICO</b>	G.S.E.B. MEXICANA, S.A. de C.V. Goldsmith 38 Desp. 401, Col. Polanco Delegacion Miguel Hildalgo 11 560 Mexico D.F.	<b>(01800) 112 8325</b>	1 años

			
<b>MOLDOVA</b>	ТОВ «Грул СЕБ Україна» Вул. Драгоманова 31 Б, офіс 1 02068 Київ, Україна	<b>(22) 929249</b>	2 ani / years
<b>NEDERLAND</b>	GROUPE SEB NEDERLAND BV Generatorstraat 6 3903 LJ Veenendaal	<b>0318 58 24 24</b>	2 jaar
<b>NEW ZEALAND</b>	GROUPE SEB NEW ZEALAND Unit E, Building 3, 195 Main Highway, Ellerslie, Auckland	<b>0800 700 711</b>	1 year
<b>NORGE</b>	GROUPE SEB NORDIC AS Tempovej 27 2750 Ballerup_DANMARK	<b>815 09 567</b>	2 år
<b>PERU</b>	GROUPE SEB COLOMBIA Av. Camino Real N° 111 of. 805 B San Isidro - Lima - Perú	<b>+511 441 4455</b>	1 años
<b>POLSKA/ POLAND</b>	GROUPE SEB POLSKA SP Z O.O. ul. Ostrobramska 79 04-175 Warszawa	<b>0801 300 422</b> koszt jak za połączenie lokalne	2 lata
<b>PORTUGAL</b>	GROUPE SEB IBÉRICA SA Urb. da Matinha Rua Projectada à Rua 3 Bloco1 - 3ª B/D 1900 - 796 Lisboa	<b>808 284 735</b>	2 anos
<b>REPUBLIC OF IRELAND</b>	GROUPE SEB IRELAND Unit B3 Aerodrome Business Park, College Road, Rathcoole, Co. Dublin	<b>01 677 4003</b>	1 year
<b>ROMÂNIA/ ROMANIA</b>	GROUPE SEB ROMÂNIA Str. Daniel Constantin nr. 8 010632 București	<b>0 21 316 87 84</b>	2 ani
<b>РОССИЯ/ RUSSIA</b>	ЗАО «Группа СЕБ-Восток», 119180 Москва, Россия Старомонетный пер. д. 14 стр.2	<b>495 213 32 37</b>	2 года/ years
<b>SRBIJA Serbia</b>	SEB Developpement Antifasisticke borbe 17/13 11070 Novi Beograd	<b>060 0 732 000</b>	2 godine
<b>SINGAPORE</b>	GROUPE SEB SINGAPORE Pty Ltd. 59 Jalan Pemimpin, #04-01/02 L&Y Building Singapore 577218	<b>65 6550 8900</b>	1 year
<b>SLOVENSKO/ SLOVAKIA</b>	GROUPE SEB SLOVENSKO s.r.o. Rybničná 40 831 07 Bratislava	<b>233 595 224</b>	2 roky
<b>SLOVENIJA</b>	SEB d.o.o Gregorčičeva ulica 6 2000 MARIBOR	<b>02 234 94 90</b>	2 leti
<b>ESPAÑA</b>	GROUPE SEB IBÉRICA S.A. Almogàvers, 119-123, Complejo Ecourban 08018 Barcelona	<b>0902 31 25 00</b>	2 años
<b>SVERIGE</b>	TEFAL SVERIGE SUBSIDIARY OF GROUP SEB NORDIC Truckvägen 14 A, 194 52 Upplands Väsby	<b>08 594 213 30</b>	2 år
<b>SUISSE SCHWEIZ</b>	GROUPE SEB SCHWEIZ GmbH Thurgauerstrasse 105 8152 Glattbrugg	<b>044 837 18 40</b>	2 ans / Jahrre
<b>TAIWAN</b>	SEB ASIA Ltd. Taipei International Building, Suite B2, 6F-1, No. 216, Tun Hwa South Road, Sec. 2 Da-an District Taipei 106, R.O.C.	<b>886-2-27333716</b>	1 year



			
<b>THAILAND</b>	GROUPE SEB THAILAND 2034/66 Italthai Tower, 14th Floor, n° 14-02, New Phetchburi Road, Bangkapi, Huaykwang, Bangkok, 10320	<b>02723 4488</b>	2 years
<b>TÜRKIYE</b>	GROUPE SEB ISTANBUL AS Beybi Giz Plaza Dereboyu Cad. Meydan Sok. No: 28 K.12 Maslak	<b>216 444 40 50</b>	2 YIL
<b>U.S.A.</b>	GROUPE SEB USA 2121 Eden Road Millville, NJ 08332	<b>800-769-3682</b>	1 year
<b>Україна/ UKRAINE</b>	ТОВ «Груп СЕБ Україна» Вул. Драгоманова 31 Б, офіс 1 02068 Київ, Україна	<b>044 492 06 59</b>	2 роки/ years
<b>UNITED KINGDOM</b>	GROUPE SEB UK Ltd. 11-49 Station Road Langley, Slough Berkshire SL3 8 DR	<b>0845 602 1454</b>	1 year
<b>VENEZUELA</b>	GROUPE SEB VENEZUELA Av Eugenio Mendoza, Centro Letonia, Torre ING Bank, Piso 15, Ofc 155 Urb. La Castellana, Caracas	<b>0800-7268724</b>	2 anno
<b>VIETNAM</b>	GROUPE SEB VIETNAM (Representative office) 127-129 Nguyen Hue Street District 1, Ho Chi Minh City, Vietnam	<b>+84-8 3821 6395</b>	1 year

# INTERNATIONAL GUARANTEE

**Date of purchase:** ..... / Date d'achat / Fecha de compra /  
Data da compra / Data d'acquisto / Kaufdatum / Aankoopdatum / Købsdato / Inkøpsdatum /  
Kjøpsdato / Ostoppäivä / Data zakupu / Data vânzării / Ísigijimo data/ Ostukuupäev / Datum nakupa  
Sorozatszám / Dátum nákupu / Pirkuma datums / Datum Kupovine / Datum kupnje / Data  
cumpărării / Datum nákupu / Tarikh pembelian / Tanggal pembelian / Ngày mua hàng/ Satın alma  
tarihi / Дата продажи / Дата продажу / Дата на закупуване / Датум на купување / Сатылган  
мерзімі / Ημερομηνία αγοράς/ Ψαδωνηη ορη /วันที่ซื้อ / 購買日期/ 購入日/ 구입일자 / تاريخ  
خريد/ تاريخ الشراء

**Product reference:** ..... / Réfêrence du produit / Referencia del  
producto / Nome do produto / tipo de prodotto / Typnummer des Gerätes / Artikelnummer van het  
apparaat / Referencenummer / Produktreferens / Artikelnummer / Tuotenumero / referencia  
produktu / Model / Gaminio numeris / Toote viitenumber / Tip aparata / Vásárlás kelte / Typ  
výrobku / Produkta atsauces numurs / Model proizvoda / Oznaka proizvoda / Cod produs / Produk  
rūjūkan / Referenssi tuote / Mã sản phẩm/ Ürün kodu / Модель / Модел на уреда /  
Модели / Κωδικός προϊόντος / Уηηηη / รุ่นผลิตภัณฑ์ / 產品模型 / 製品レファレンス番号 / 제품명 /  
مرجع المنتج الكامل / مرجع كامل محصول

**Retailer name & address:** .....  
/ Nom et adresse du vendeur / Nombre y dirección del minorista / Nome e endereço do revendedor  
/ Nome e indirizzo delnegozio / Name und Anschrift des Händlers / Naam en adres van de dealer /  
Forhandler navn & adresse / Återförsäljarens namn och adress / Forhandler navn og adresse /  
Jälleenmyyjän nimi ja osoite / nazwa i adres sprzedawcy / Numele și adresa vânzătorului /  
Parduotuvės pavadinimas ir adresas / Mütija kauplus ja aadress / Naziv in naslov trgovine /  
Tipusszám / Názov a adresa predajcu / Veikala nosaukums un adrese / Naziv i adresa malprodaje /  
Naziv i adresa prodavca / Naziv i adresa prodajnog mjesta / Nume și adresă vânzător / Název a  
adresa prodejece / Nama dan alamat peruncit / Nama Toko Penjual dan alamat / Tên và địa chỉ cửa  
hàng bán/ Satici firmanın adı ve adresi / Название и адрес продавца / Назва і адреса продавця /  
Търговки обект / Назив и адреса на продавницата / Сатушының аты және мекен-жайы /  
Επωνυμία και διεύθυνση καταστήματος / Ψαδωνηηη ηηηηηηηη η ηηηηηηηη η ηηηηηηηη /  
ชื่อและที่อยู่ของห้าง/ร้านที่ซื้อ / 零售商的店名和地址/販売店の名前、住所/소매점 이름과 주소/  
نام ودرس خرده فروش / اسم بائع التجزئة و عنوانه

**Distributor stamp** ..... /Cachet distributeur /Sello del distribuidor /  
Carimbo do revendedor / Timbro del negozio / Händlerstempel / Stempel van de dealer /  
Forhandler stempel / Återförsäljarens stämpel / Forhandler stempel / Jälleenmyyjän leima / pieczęć  
sprzedawcy / Ştampila vânzătorului / Antspaudas / Tempel / Žig trgovine / Eladó neve, címe/  
Razitko predajcu / Zímogs / Pečat malprodaje/ Pečat prodavca / Pečat prodajnog mjesta / Ştampila  
vânzătorului/ Razitko prodejece/ Cap peruncit / Cap dari Toko Penjual / Cửa hàng bán đồng dấu/  
Satici Firmanın Kaşesi / Печать продавца / Печатка продавця / Печат на търговския обект /  
Печат на продавницата / Сатушының мөрі / Σφραγίδα καταστήματος / Ψαδωνηηη ηηηηηηηη ηηηηηηηη /  
ตราประทับของห้าง/ร้านที่ซื้อ / 零售商的蓋印/販売店印/소매점 직인/التجزئة/مهر خرده  
فروش



Réf : NC00117666



création **BATOTEAM** : [www.batoteam.fr](http://www.batoteam.fr)